

PCB Series Clutch/Brake

PCB-1225 Heavy Duty



Unit Size	PCB-1225	
	Wt. (lbs.)	Inertia (lbs.ft. ²)
Magnet - Brake	18.557
Magnet - Clutch	18.557	3.245
Magnet Hub Assembly	7.252	.461
Bushing: Max. Bore to	4.055	.085
Min. Bore.....	9.141	.133
Armature & Pins	10.84	1.7

Item	Description	Part Number	Qty.
1	Splined Hub	540-0148	1
2	Mounting Accessory	5202-101-001	1
3	Armature Assembly	5323-111-001	1
3-1	Armature	5323-111-034	1
3-2	Armature Adapter	104-0010	1
3-3	Autogap Spring	808-0044	1
3-4	Retainer Ring	748-0370	1
3-5	Buttonhead Screw	797-0281	3
3-6	Locknut	661-0005	3
4	Mounting Accessory	5321-101-001	1
5	Magnet		1
	6 Volt	5303-631-005	
	24 Volt	5303-631-007	
	90 Volt	5303-631-008	
	†90 Volt LK Facing	5303-631-001	
5-1	Terminal Accessory	5311-101-001	1
6	Magnet Hub		1
	Right Hand	5303-541-002	
	Left Hand (shown)	5303-541-001	
6-1	Collector Ring	5301-749-001	1
6-2	Collector Ring Accessory	5303-101-004	1
7	Bushing*	180-0262 to 180-0295	1
8	Brushholder	5300-178-001	1
8-1	Brush	176-0001	4
9	Armature	5303-111-009	1
10	Autogap Accessory	5201-101-008	4
11A	Mounting Accessory		
	Inside Mounted	5321-101-001	1
11B	Mounting Accessory		
	Outside Mounted	5321-101-002	2

Drawing I-25588

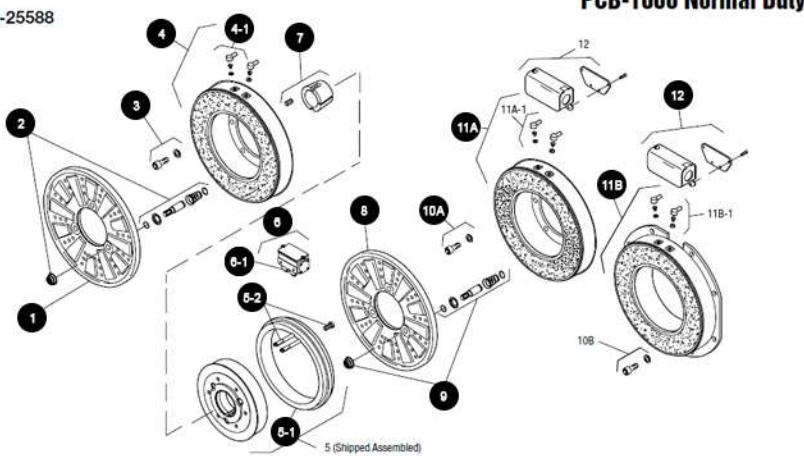

PCB-1000 Normal Duty

Bushing Part Numbers

Shaft Size	Keyway Size	Warner Electric
1/2	1/8 x 1/16	180-0185
9/16	1/8 x 1/16	180-0186
5/8	3/16 x 3/32	180-0187
11/16	3/16 x 3/32	180-0188
3/4	3/16 x 3/32	180-0189
13/16	3/16 x 3/32	180-0190
7/8	3/16 x 3/32	180-0191
15/16	1/4 x 1/8	180-0192
1	1/4 x 1/8	180-0193
1 1/16	1/4 x 1/8	180-0194
1 1/8	1/4 x 1/8	180-0195
1 3/16	1/4 x 1/8	180-0196
1 1/4	1/4 x 1/8	180-0197
1 5/16	5/16 x 5/32	180-0198
1 3/8	5/16 x 5/32	180-0199
1 7/16	3/8 x 3/16	180-0200
1 1/2	3/8 x 3/16	180-0201
1 9/16	3/8 x 3/16	180-0202
1 5/8	3/8 x 3/16	180-0203

1 11/16	3/8 x 3/16	180-0204
1 3/4	3/8 x 3/16	180-0205
1 13/16	1/2 x 1/4	180-0206
1 7/8	1/2 x 1/4	180-0207
1 15/16	1/2 x 1/4	180-0208
2	1/2 x 1/4	180-0209
2 1/16	1/2 x 1/4	180-0210
2 1/8	1/2 x 1/4	180-0211
2 3/16	1/2 x 1/4	180-0212
2 1/4	1/2 x 1/4	180-0213
2 5/16	5/8 x 5/16	180-0214
2 3/8	5/8 x 5/16	180-0215
2 7/16	5/8 x 5/16	180-0216
2 1/2	5/8 x 5/16	180-0217

Item	Description	Part Number	Qty.
12A	Magnet - Inside Mounted		1
	6 Volt	5313-631-005	
	24 Volt	5313-631-006	
	90 Volt	5313-631-007	
	†90 Volt LK Facing	5313-631-001	
12A-1	Terminal Accessory	5311-101-001	1
12B	Magnet - Outside Mounted		1
	6 Volt	5313-631-010	
	24 Volt	5313-631-012	
	90 Volt	5313-631-011	
	†90 Volt LK Facing	5313-631-002	
12B-1	Terminal Accessory	5311-101-001	1
13	Conduit Box	5200-101-010	1